

OVERALL EXISTING CONDITIONS PLAN FOR MCCLURE STATION PARK

McCLURE BOROUGH, SNYDER COUNTY, PENNSYLVANIA

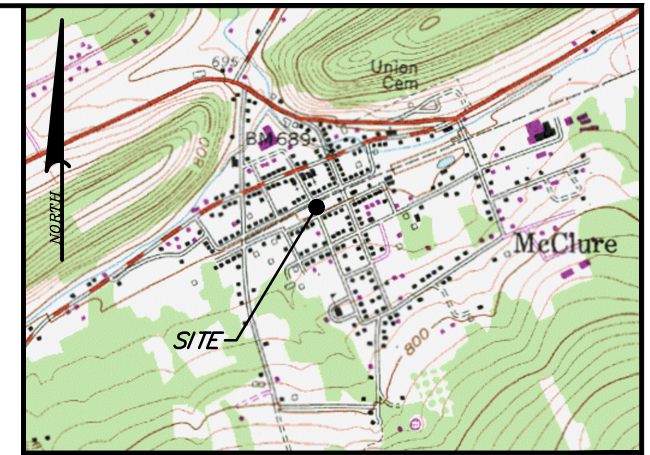

SITE LOCATION
SCALE 1"=2,000'
USGS QUADRANGLE - MCCLURE

N. Schoch St.

S. Brown St.

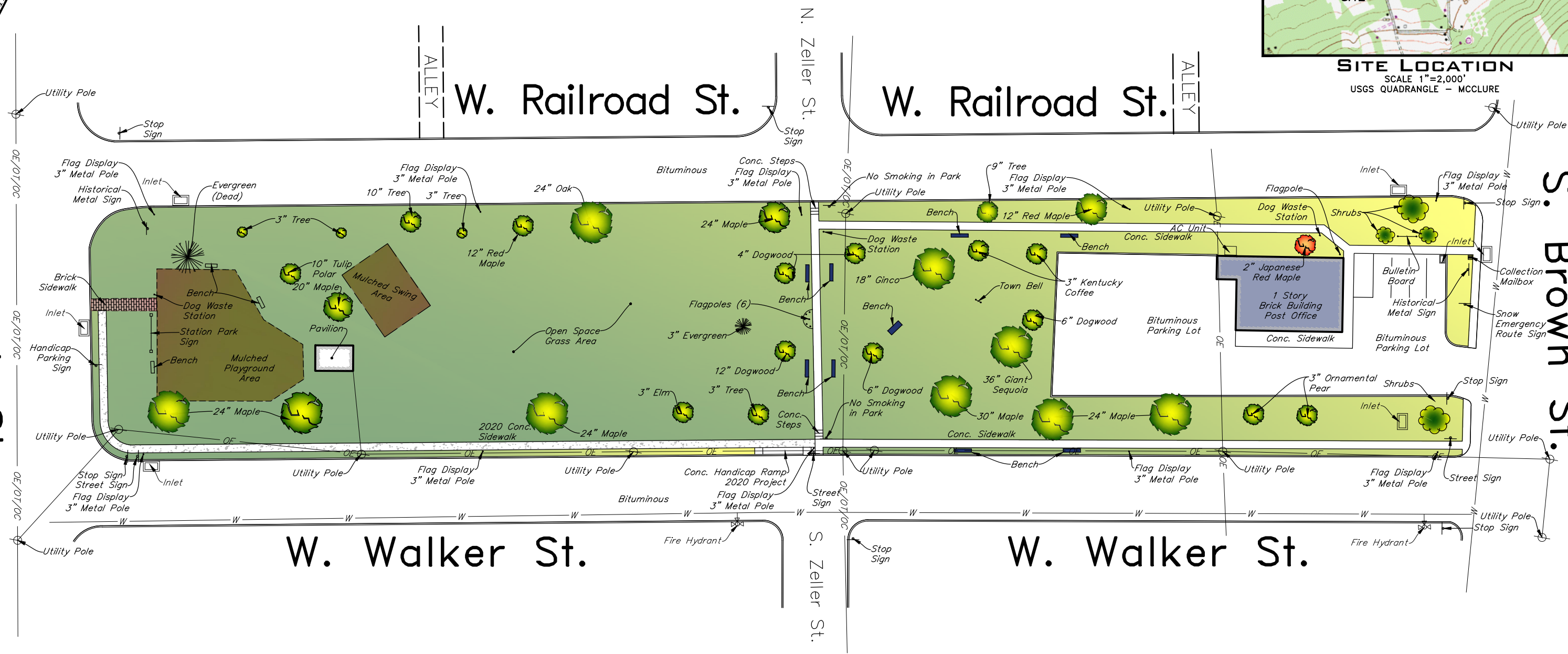

SITE DATA

Owner: McClure Borough
Address: 1 N. Forbes St.; P.O. Box 407
McClure, Pa 17841
(McClure Borough, Snyder County)
Tax Parcel: 09-01-387 (Includes 09-01-386)
Document: Deed Book 110, Page 629

GENERAL NOTES

1. THIS PLAN DOES NOT REPRESENT AN ACTUAL FIELD SURVEY AND SHOULD NOT BE USED TO PULL DIMENSIONS.
2. THIS PLAN WAS NOT DONE BY ANY SURVEYING OR ENGINEERING FIRM, PERSON COMPLETING THIS PLAN DOES WORK FOR AN ENGINEERING COMPANY, BUT DIDN'T DO THIS PLAN THROUGH THE COMPANY.
3. EACH PHASE MAY HAVE SUB-PHASES AND MAY NOT ALL NEED TO BE COMPLETED AT ONCE, OR IN THE SAME CALENDAR YEAR.
4. PLAN WAS CREATED FOR THE PURPOSE OF THE MCCLURE STATION PARK STRATEGIC COMPREHENSIVE PLAN AND THE PHASES WILL BE REFLECTED IN THE STRATEGIC COMPREHENSIVE PLAN IN ADDITION TO THE DETAILS FOR ITEMS TO BE COMPLETED DURING EACH PHASE.
5. THERE IS A DRAINAGE ISSUE ON WEST RAILROAD STREET BETWEEN THE ALLEY TO NORTH SCHOCH STREET (SOUTH SIDE OF STREET). ISSUE OF POOLING WATER CAN BE SOLVED WHEN THE ROAD IS PAVED (RAISE THE PAVING HIGHER IN THIS LOCATION); NO NEED FOR ADDITIONAL PIPING.

SHEET INDEX

- SHEET 1 - OVERALL EXISTING CONDITIONS PLAN
- SHEET 2 - PROPOSED LAND DEVELOPMENT - PHASE 1 & 1.5
- SHEET 3 - PROPOSED LAND DEVELOPMENT - PHASE 2 & 2.5
- SHEET 4 - PROPOSED LAND DEVELOPMENT - PHASE 3
- SHEET 5 - PROPOSED LAND DEVELOPMENT - PHASE 4
- SHEET 6 - OVERALL DEVELOPED PARK

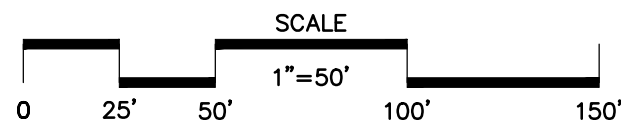

PROPOSED LAND DEVELOPMENT - PHASE 1 & 1.5 FOR MCCLURE STATION PARK

McCLURE BOROUGH, SNYDER COUNTY, PENNSYLVANIA

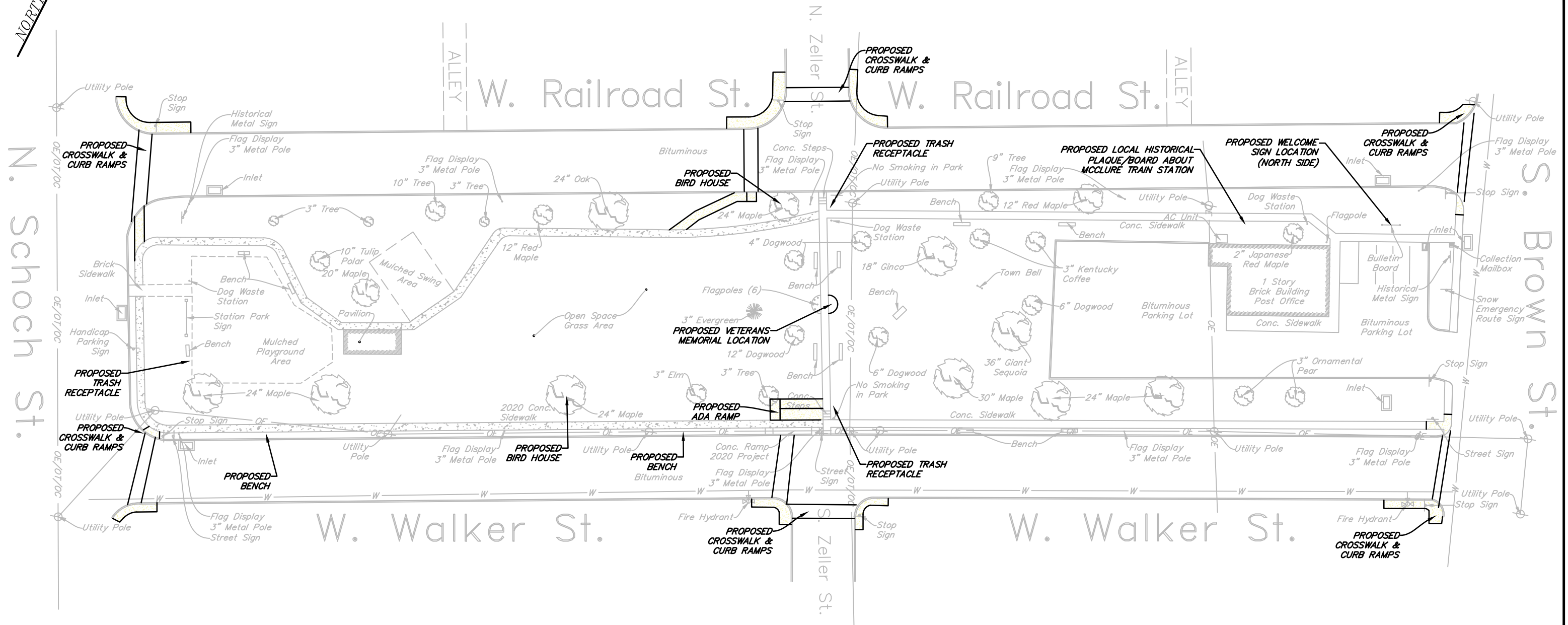
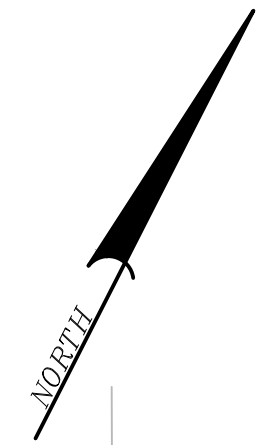

ITEMS TO BE COMPLETED IN PHASE 1 & 1.5

DETAILS OF THE ITEMS LISTED BELOW ARE LOCATED IN THE MCCLURE STATION PARK STRATEGIC COMPREHENSIVE PLAN.

1. SIGN ON THE BACK OF THE BULLETIN BOARD; WELCOME TO STATION PARK
2. LOCAL HISTORICAL PLAQUE/BOARD DISPLAYING INFORMATION ABOUT THE MCCLURE TRAIN STATION.
3. VETERANS MEMORIAL IN THE CENTER OF THE PARK LOCATED ACROSS FROM THE FLAG POLES.
4. BIRD HOUSES AND BIRD FEEDERS (HUNG IN THE DOGWOOD TREES).
5. TRASH RECEPTACLES (SEE ABOVE FOR PROPOSED LOCATIONS).
6. PARK BENCHES

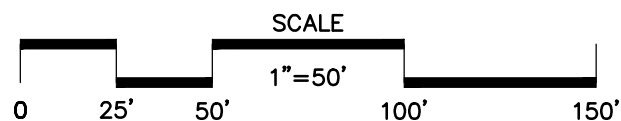

PROPOSED LAND DEVELOPMENT - PHASE 2 & 2.5 FOR McCLURE STATION PARK

McCLURE BOROUGH, SNYDER COUNTY, PENNSYLVANIA

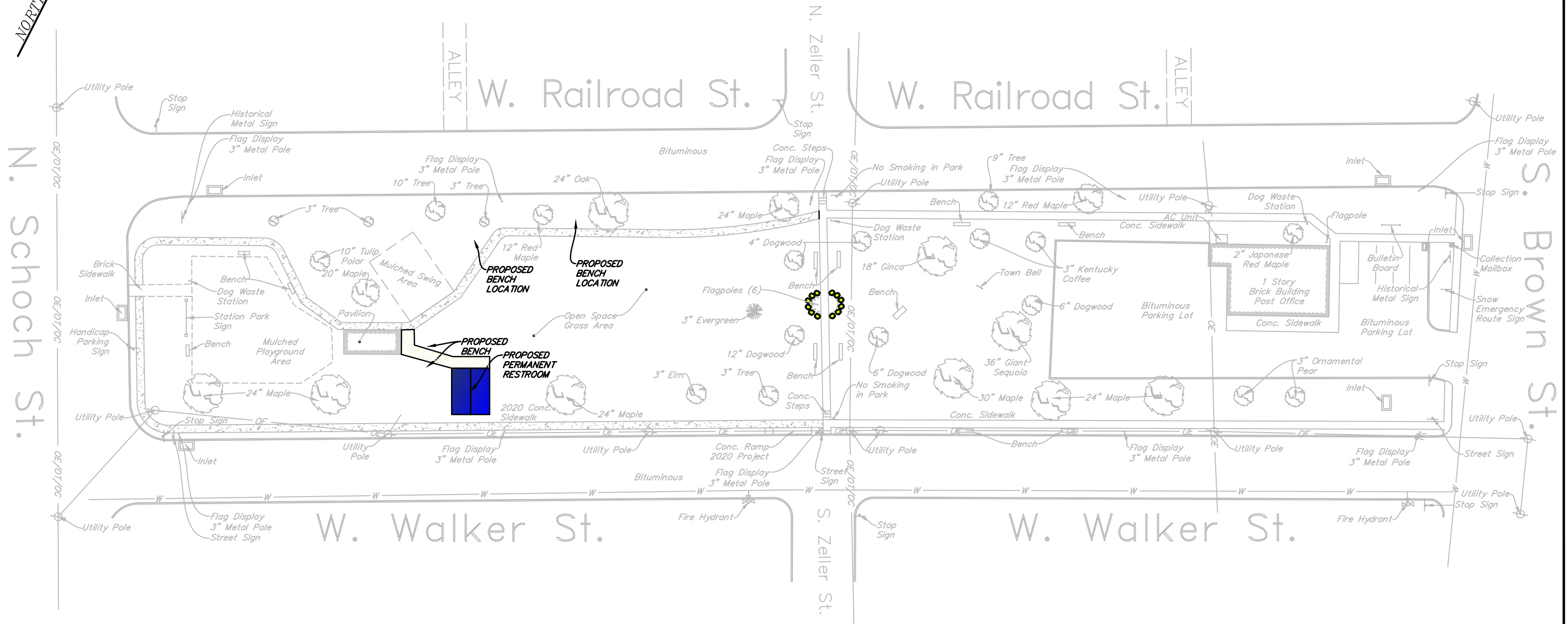
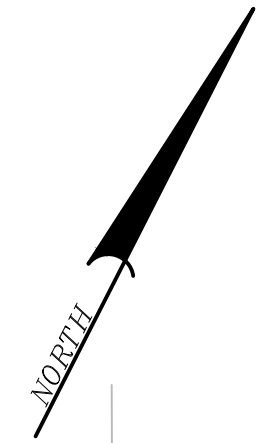

ITEMS TO BE COMPLETED IN PHASE 2 & 2.5

DETAILS OF THE ITEMS LISTED BELOW ARE LOCATED IN THE McCLURE STATION PARK STRATEGIC COMPREHENSIVE PLAN.

1. PERMANENT RESTROOM.
2. WATER DRINKING FOUNTAIN.
3. PARK BENCHES ALONG NEW TRAIL AND SIDEWALK.
4. LANDSCAPING AROUND THE VETERANS MEMORIAL AND FLAG POLES.

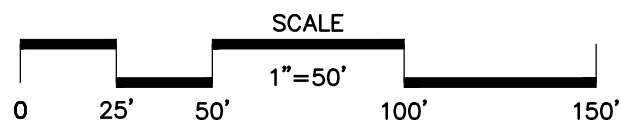

PROPOSED LAND DEVELOPMENT - PHASE 3 FOR MCCLURE STATION PARK

McCLURE BOROUGH, SNYDER COUNTY, PENNSYLVANIA

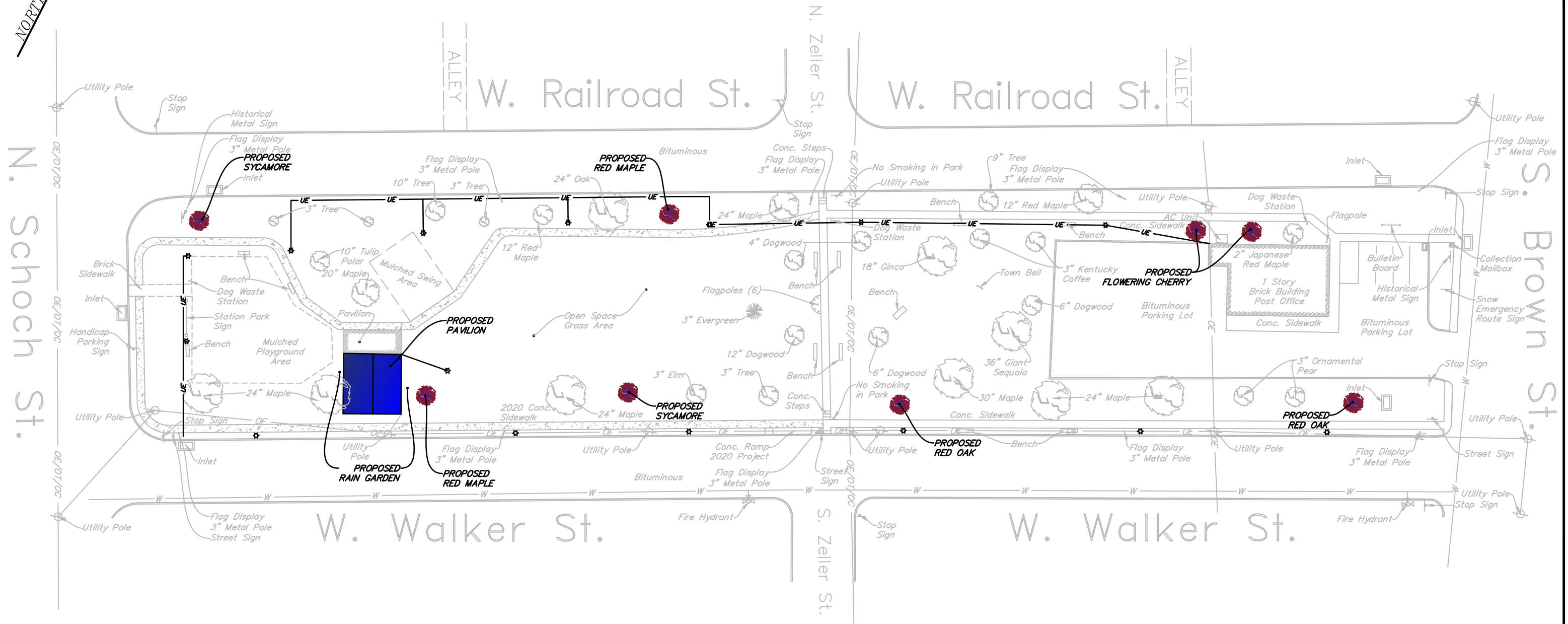
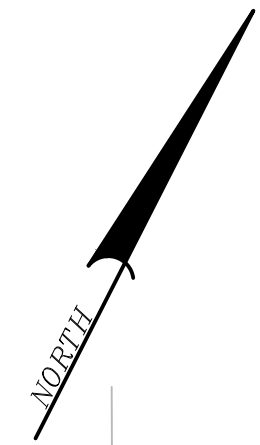

ITEMS TO BE COMPLETED IN PHASE 3

DETAILS OF THE ITEMS LISTED BELOW ARE LOCATED IN THE MCCLURE STATION PARK STRATEGIC COMPREHENSIVE PLAN.

1. LIGHTING AROUND THE PARK, TRAILS, SIDEWALKS AND OTHER LOCATIONS. ELECTRIC LINES ON THIS PLAN ARE APPROXIMATE LOCATIONS AND THE CONTRACTOR FOR THE ELECTRICITY WILL DETERMINE WHERE TO PUT IT EXACTLY. ALL POWER WILL COME OUT OF THE POST OFFICE IN THE NORTHWEST CORNER OF THE BUILDING. TOTAL OF 15 LIGHTS PROPOSED FOR AROUND THE PARK.
2. ADDITIONAL PAVILION WITH PICNIC TABLES, TRASH RECEPTACLES AND RECYCLING CONTAINER.
3. ADDITIONAL TREES PLANTED DURING THIS PHASE WOULD BE RED MAPLES, SYCAMORES, FLOWERING CHERRY OR RED BUDS AND RED OAKS.

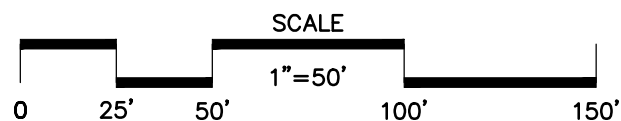

PROPOSED LAND DEVELOPMENT - PHASE 4 FOR McCLURE STATION PARK

McCLURE BOROUGH, SNYDER COUNTY, PENNSYLVANIA

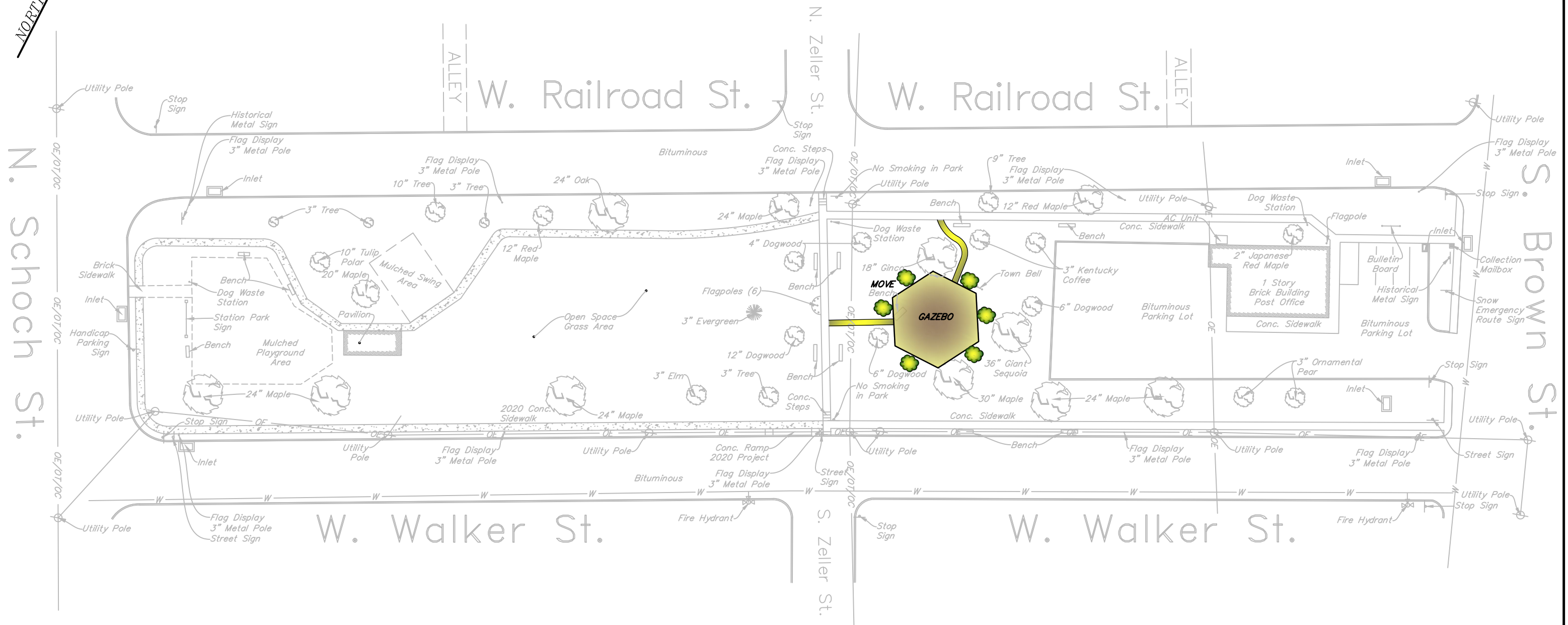
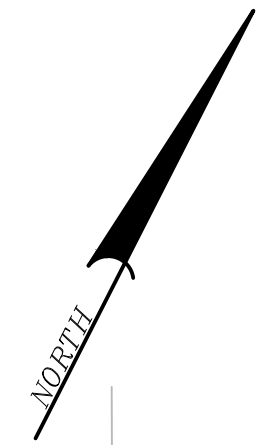

ITEMS TO BE COMPLETED IN PHASE 4

DETAILS OF THE ITEMS LISTED BELOW ARE LOCATED IN THE McCLURE STATION PARK STRATEGIC COMPREHENSIVE PLAN.

1. AN ENTERTAINMENT GAZEBO WITH LANDSCAPING AROUND IT, LIGHTING INSIDE WITH BENCHES AROUND THE INSIDE. GAZEBO STYLED AFTER CAMERON PARK GAZEBO IN SUNBURY, PENNSYLVANIA (SEE THE COMPREHENSIVE PLAN FOR AN IMAGE OF THE CAMERON PARK GAZEBO). THIS GAZEBO WOULD ALSO HAVE CRACKER DUST TRAILS AND STEPS COMING FROM TWO LOCATIONS.

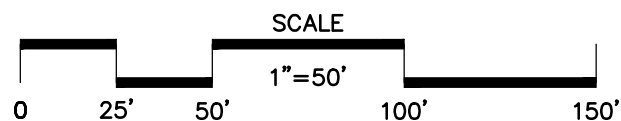

OVERALL EXISTING CONDITIONS PLAN FOR PHASE 5 - EXPANSION OF STATION PARK NEW PARK - "TRACKS PARK"

McCLURE BOROUGH, SNYDER COUNTY, PENNSYLVANIA

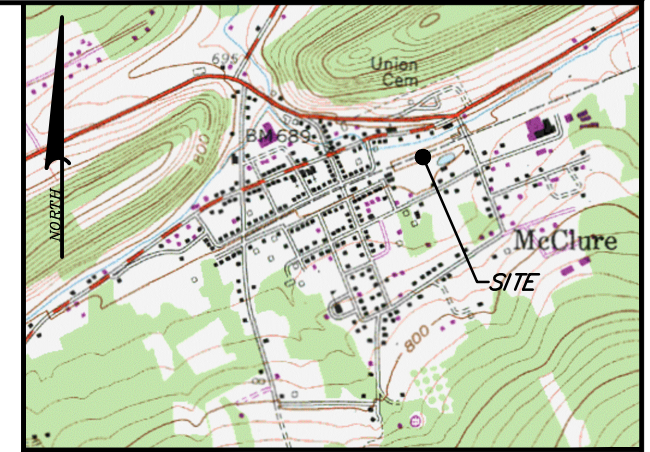
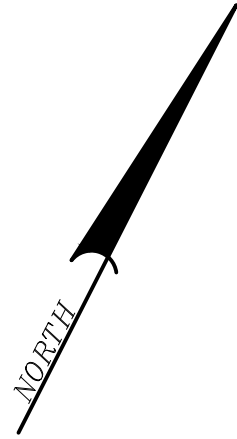

SITE LOCATION
SCALE 1"=2,000'
USGS QUADRANGLE - MCCLURE

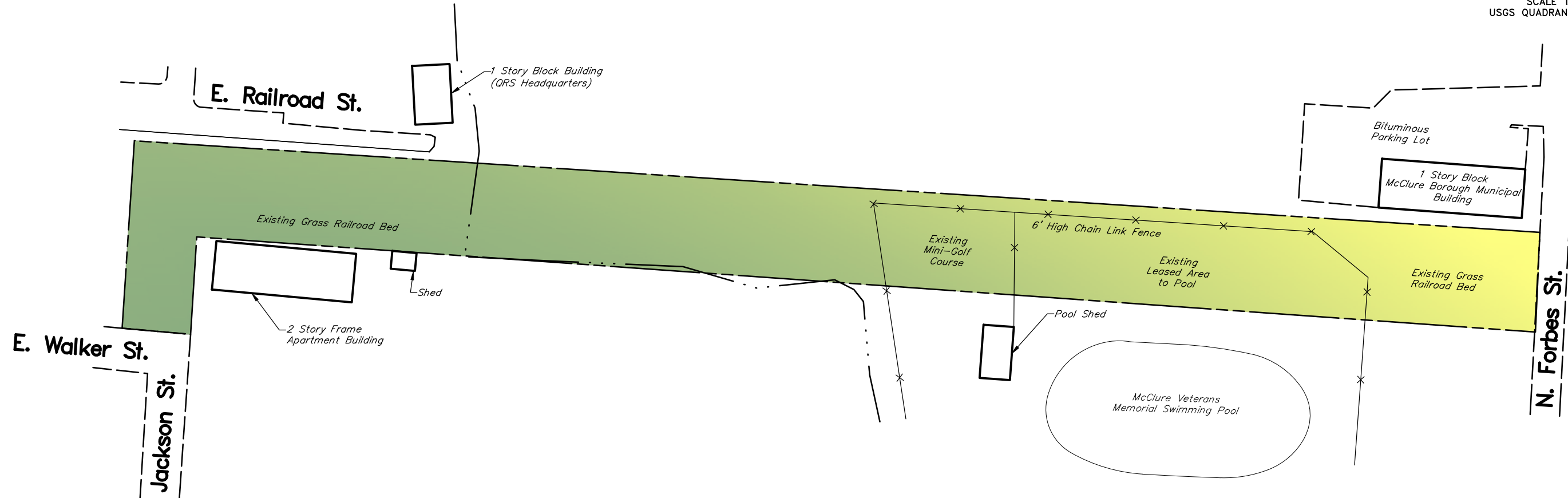

SITE DATA

Owner: McClure Borough
Address: 1 N. Forbes St.; P.O.Box 407
McClure, Pa 17841
(McClure Borough, Snyder County)
Tax Parcel: 09-01-387 (Includes 09-01-386)
Document: Deed Book 110, Page 629

GENERAL NOTES

1. THIS PLAN DOES NOT REPRESENT AN ACTUAL FIELD SURVEY AND SHOULD NOT BE USED TO PULL DIMENSIONS.
2. THIS PLAN WAS NOT DONE BY ANY SURVEYING OR ENGINEERING FIRM, PERSON COMPLETING THIS PLAN DOES WORK FOR AN ENGINEERING COMPANY, BUT DIDN'T DO THIS PLAN THROUGH THE COMPANY.
3. EACH PHASE MAY HAVE SUB-PHASES AND MAY NOT ALL NEED TO BE COMPLETED AT ONCE, OR IN THE SAME CALENDAR YEAR.
4. PLAN WAS CREATED FOR THE PURPOSE OF THE MCCLURE STATION PARK STRATEGIC COMPREHENSIVE PLAN AND THE PHASE 5 WILL BE REFLECTED IN THE STRATEGIC COMPREHENSIVE PLAN IN ADDITION TO THE DETAILS FOR ITEMS TO BE COMPLETED DURING EACH PHASE.
5. THE NEW EXPANSION OF THE PARK WILL BE LOCATED FROM AN EXISTING APARTMENT BUILDING AND FORBES STREET; WHICH IS JUST EAST OF THE CURRENT MCCLURE STATION PARK. IT IS OWNED BY THE MCCLURE BOROUGH AND IT IS A EXISTING GRASS RAILROAD BED.

SHEET INDEX

SHEET 1 - OVERALL EXISTING CONDITIONS PLAN
SHEET 2 - PROPOSED LAND DEVELOPMENT - PHASE 5

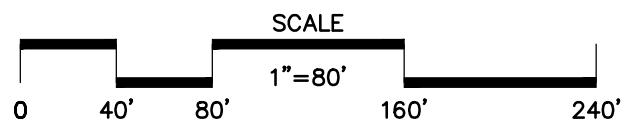

PHASE 5 - EXPANSION OF STATION PARK NEW PARK - "TRACKS PARK"

McCLURE BOROUGH, SNYDER COUNTY, PENNSYLVANIA

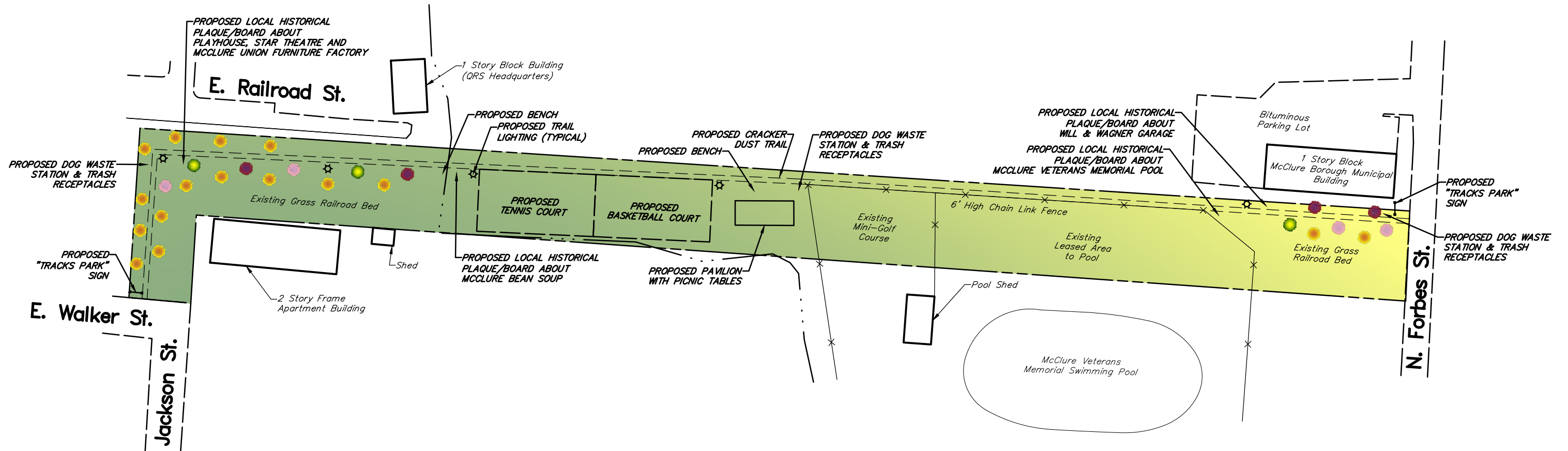
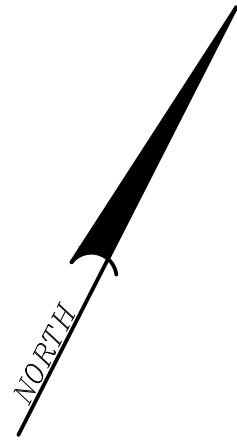

ITEMS TO BE COMPLETED IN PHASE 5 - EXPANSION

DETAILS OF THE ITEMS LISTED BELOW ARE LOCATED IN THE McCLURE STATION PARK STRATEGIC COMPREHENSIVE PLAN. THESE DO NOT ALL NEED TO BE COMPLETED AT ONCE.

1. A SIGN AT EACH ENTRANCE TO THE PARK.
2. CRACKER DUST WALKING AND BIKING TRAIL.
3. TENNIS AND BASKETBALL COURTS.
4. LOCAL HISTORICAL PLAQUES BOARDS.
5. LIGHTING ALONG THE TRAIL AS WELL AS BENCHES.
6. PARK PAVILION WITH PICNIC TABLES.
7. TRASH RECEPTACLES AND DOG WASTE STATIONS (THREE).
8. LANDSCAPING - THREE DIFFERENT TYPES OF TREES TO BE PLANTED.
 - 8.1. RED MAPLE - SHOWN IN DARK PURPLE
 - 8.2. RED OAK - SHOWN IN GREEN
 - 8.3. FLOWERING CHERRY - SHOWN IN PINK
 - 8.4. FRUIT TREES - SHOWN IN YELLOW/RED

